

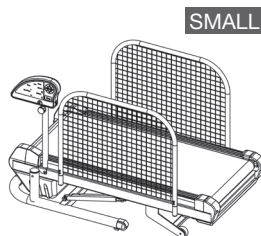

Dog Treadmills

MODELS

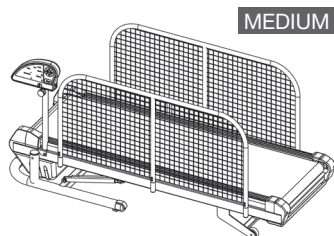
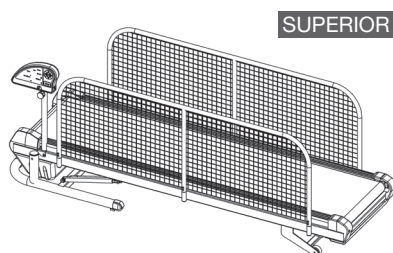
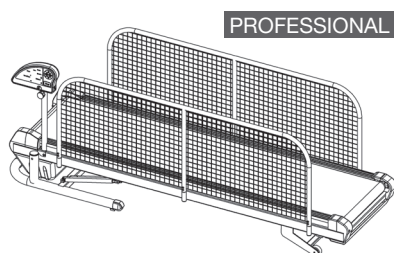

In order to operate this treadmill safely and correctly, please read the manual and follow the instructions carefully.

CONTENTS

Assembly Instructions | Parts List | Gradient Adjustment
Belt Tension Adjustment | Computer Console Instructions
Maintenance Instructions | Dog Training Manual
Technical Specifications | Warranty

Assembly instructions

- Fit Fur Life treadmills are robust, so they are also heavy! It is advisable that two people lift, carry and position the treadmill.
- For protection during transit each treadmill is packed in three layers of boxes. If the machine has been damaged in transit, FFL must be notified within 48 hours, please refer to the Terms and Conditions section.
- Remove the treadmill from the box and place on level ground. Watch our video on the website under Owners Manual.
- Fix the side fences left and right to the machine using the screw M6x10L. All the machines have the same assembly
- To connect the upright pole with the console attached, connect the 6 pin plug to the connector on the left hand side of the machine at the front. Using the M6x15L screws fix the upright pole into position.
- Make sure all cables are connected and screws fully tightened before using the treadmill.

PROFESSIONAL MODEL

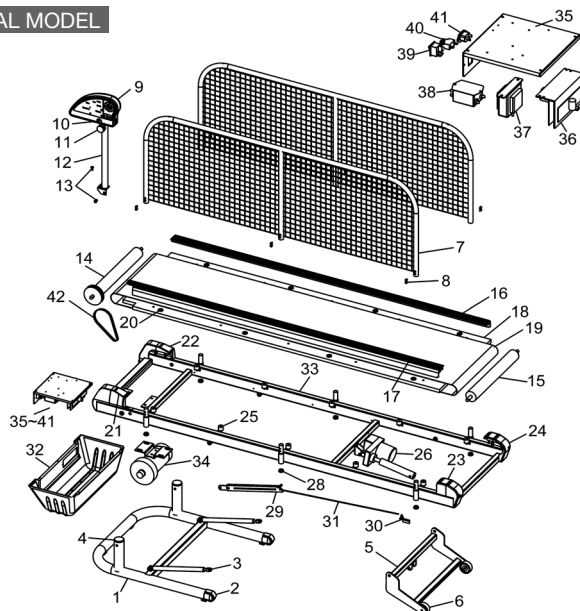

SUPERIOR MODEL

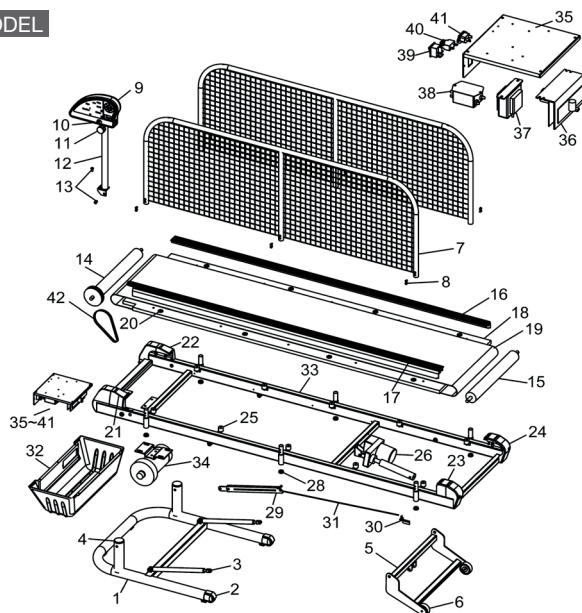

MEDIUM MODEL

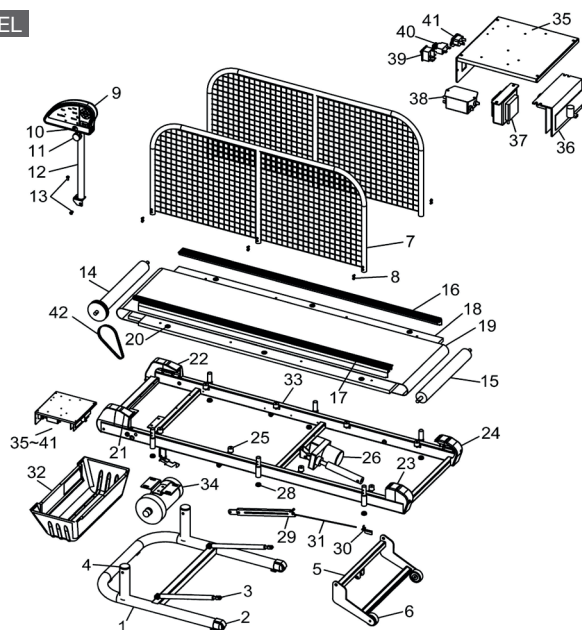

SMALL MODEL

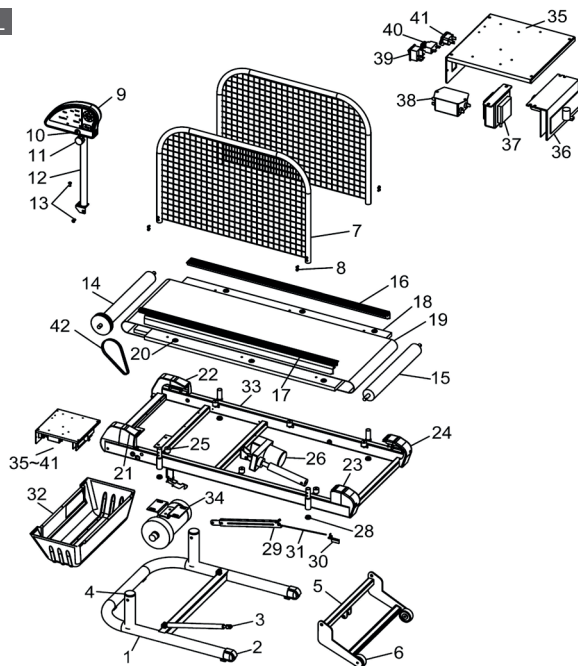

Parts list

NO	DESCRIPTION	QTY	NO	DESCRIPTION	QTY	NO	DESCRIPTION	QTY
1	BASE FRAME	1	15	REAR ROLLER	1	29	LOCKER SET	1
2	MOVING WHEEL	2	16	SIDE PANEL -R	1	30	LOCKER HANDLE	1
3	AIR CYLINDER	1	17	SIDE PANEL -L	1	31	BRAKE WIRE	1
4	Ø2" END CAP	2	18	WOOD PLATE	1	32	MOTOR COVER	1
5	BRACKET	1	19	RUNNING BELT	1	33	MAIN FRAME	1
6	REAR WHEEL	2	20	GUIDE PAD	6	34	MOTOR	1
7	GUARDRAILS	2	21	FRONT END CAP -L	1	35	MCB BASE	1
8	BOLT M6X10	8	22	FRONT END CAP -R	1	36	CONTROL BOARD	1
9	CONSOLE	1	23	REAR END CAP -L	1	37	CHOKE	1
10	YELLOW SAFETY KEY	1	24	REAR END CAP -R	1	38	EMC FILTER	1
11	BLACK KNOB	1	25	SUSPENSION PAD	6	39	POWER SWITCH	1
12	CONSOLE POLE	1	26	INCLINE MOTOR	1	40	OVER CURRENT PROTECTOR	1
13	BOLT M8X15	2	-	-	-	41	SOCKET	1
14	FRONT ROLLER	1	28	Ø1" END CAP	4	42	MOTOR BELT	1

Computer console instructions

Watch the video on our website under Owners Manual.



1. There is an ON/OFF switch located where the power lead comes into the treadmill at the front of the machine. Use this to turn the power on and off at the machine.
 2. Turn on the power, the distance window will display “hold” for about 5 seconds, then all the windows display 0.00.
The YELLOW SAFETY KEY must be inserted in the SAFETY KEY position in order for the treadmill to work. Attach the safety key to the harness to act as a safety mechanism when the dog is on the treadmill. Pull manually in case of emergency.
 3. • Before you start the machine please select whether you would like MPH or KMH which is via a button on the side of the console. It then indicates what you have selected on the front of the console by the speed display.
 - The Start button on the console starts the belt moving
- Start:** Press Start button on the console to start the belt moving.
Press upwards arrow key or downwards arrow key to adjust the speed.
- Stop:** Press once to pause the belt moving
Press twice to stop the belt moving
4. While the dog is on the machine the speed, time and distance will be recorded.
 5. Once the belt is moving use the arrow keys to adjust the speed.

6. To set a 3, 6, 10, 30 minute programme you need to select the time before you press start.

Time setting: Press leftwards arrow key to select the time window, and press upwards arrow key or downwards arrow key to adjust the time. Then press start to start to countdown.

7. All the models have the incline and decline feature. Select the Slope display on the console by using the arrow keys. Once it is showing the selection of the slope display use the arrow keys to adjust it.

Slope setting: Press leftwards arrow key to select the slope window, and press upwards arrow key or downwards arrow key to adjust the slope.

1. To raise the gradient, press the arrow keys once the slope option has been selected.
2. To lower the gradient, press the arrow keys once the slope option has been selected.

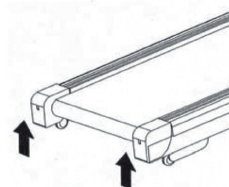

8. Remove and replace the YELLOW SAFETY KEY between using the treadmill for one dog and another.

Belt tension adjustment

A. To adjust belt tension:

1. Keep the machine running, at approximately 4 mph.
2. Insert a 5 mm Allen key into the REAR END CAP and as shown below turn the bolts evenly a full clockwise rotation.
3. If the belt continues to slip during use, repeat the above steps until the slipping stops.

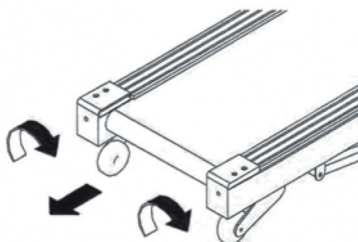

B. To centre the belt:

1. Place the treadmill on a level surface.
2. Keep the machine running, at approximately 4 mph.
3. If the belt drifts to the right, turn the right-hand adjustment bolt 1/2 turn clockwise.
4. If the belt drifts to the left, turn the left-hand adjustment bolt 1/2 turn clockwise.
5. If the belt is not centred in 15 seconds, repeat step 3 or step 4 as appropriate.

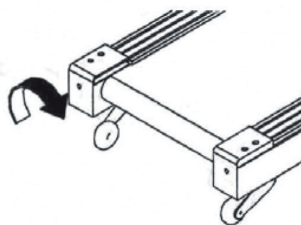
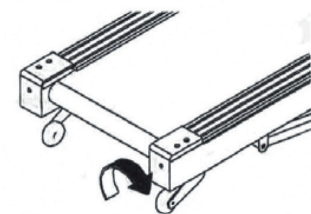

How to adjust the torque:

Press upwards arrow key and downwards arrow key in the meantime until number (ex:34) shows on slope window. Press upwards arrow key or downwards arrow key to adjust the torque. Then press start to complete the setting. After completing the torque setting, power off and power on to re-start the treadmill.

Maintenance instructions

1. Damp and dirt are not good for the machine so it is important that the treadmills are kept in dry and clean areas. If the electronic components get wet, turn the machine off and do not turn it on again until thoroughly dry.
2. Each new treadmill is provided with a bottle of lubricant. Turn the machine on whilst applying the lubricant. Watch our video on the website under owners manual.
3. With all the models insert the nozzle of the lubricant bottle between the running belt and the running board. Use half a bottle each side of the treadmill belt. Top up once a month or more if in heavy use, with sewing machine oil or 3in1 oil.
4. Regularly vacuum the hair off the treadmill and keep the machine clean and free from debris such as dog biscuit crumbs.
5. Do not soak the belt in water. Clean the treadmill using a damp cloth and a non-abrasive cleaning agent.
6. Please make sure that you read the Terms and Conditions booklet.



Dog Training Manual

When first using the treadmill

- When first introducing your dog always ensure that it is a positive experience. Use a treat, biscuit or toy to make this a fun experience for both you and the dog.
- You are training the dog to use a treadmill. Just the same as if you are training them to be obedient, or using agility equipment etc.
- The dog needs to have its attention on you, just as he/she would if you were teaching it a new command.
- Start by having your dog on a lead. The lead must be slack all the time. The object of the treadmill is to encourage the dog to stand up on its own rather than leaning on a tight lead.
- Walk the dog on to the treadmill from the back and off the machine at the front. Again walk the dog on and off the treadmill until it is relaxed. The treadmill must always be in the 0% gradient (horizontal) position and on stand-by.
- Allow your dog to sniff and explore the treadmill. Reward and praise your dog.
- You need to find some reward that your dog is extremely interested in, a biscuit, sausage pieces, cheese pieces, any dog treats or a toy. Encourage your dog to take the treat from your hand and play with the dog a little to keep his/her attention on you.

- When your dog is relaxed and his/her attention is solely on you, press the on/off switch and allow the treadmill to start moving.
- The treadmill starts etc at 0.4km/hr or 0.25m/hr with the Professional and Superior and 0.8km/hr or 0.5m/hr with the Small and Medium. Your dog will drift backwards on the treadmill belt, encourage it to walk forwards, and then it will drift back again, and again encourage it to walk forwards. This is quite normal however if the dog looks seriously unsettled stop the machine. Remember at this stage you are merely introducing your dog to the treadmill.
- After 30 seconds or so switch the treadmill off. Reward and praise your dog.
- Repeat this 4 – 5 times. Praising and encouraging your dog. Please try to keep a slack lead so that your dog can move its head and examine what is going on. Keep it fun and keep his/her attention on you. It also allows the dog to learn to carry itself properly which is very important for even muscular development to happen all over the body.
- Repeat this process twice a day for about two to three days.
- When you feel your dog understands that the treadmill starts and stops, use the arrow keys, and the speed will increase by 0.1km/hr and less than 0.1m/hr.
- Only you will be able to tell when your dog is walking at a comfortable pace, by watching it. Your dog must be comfortable in its walking gait for a few days before pushing it to a striding out gait.
- Decline function is available for all the treadmills

Trotting and using incline and decline functions

TROTTING

- After 1 – 3 weeks you can either teach the dog to trot or start to use the incline and decline features. Some dogs will take to these changes much quicker than others.
- Every single dog is an individual. Please treat them with respect and don't expect one to be achieving at the same rate as his or her kennel mate.
- When trotting your dog you must be by its side at all times.

Always introduce the dog to trotting with the treadmill in the horizontal position. Bring the dog up to their striding out gait; this is individual for each dog. Then set the speed for a trot pace which is again different for each breed of dog and each individual.



Here is a rough guide:

- For miniature breeds trotting can take place between 1.25 and 3 mph (2 and 5km/hr)
- For small breeds trotting can take place between 2.5 and 3.75 mph (4 and 6km/hr)
- For medium breeds trotting can take place between 3 and 5 mph (5 and 8km/hr)
- For large breeds trotting can take place between 4.5 and 6.25 mph (7 and 10km/hr)
- For giant breeds trotting can take place between 7.5 and 10 mph (12 and 16km/hr)

NOTE: These are wide ranges and your dog might be different.

- There is a time delay of 3 seconds before the treadmill reaches the speed that you have set, this allows the dog to break into a trot pace comfortably. You need to give lots of encouragement at this point and tell them to trot on.
- Once it is trotting decrease/increase the speed so that the dog can remain trotting comfortably. This is a very intense pace and they need to concentrate on what they are doing. When they trot for the first time just trot for 30 seconds and then bring them back down to a walk. Slowly build up from here.

INCLINE FUNCTION

- When introducing your dog to the incline function, he/she should be totally comfortable with the walking gait and striding out gait.
- The incline feature is the same for all 5 of the Fit Fur Life models and adjusts very finely in single increments. It is motorized, quiet and smooth. It is a maximum of 3.5% each way.
- Your dog really should not even notice you adjusting it.
- Make sure your dog is in a walking gait for a few minutes of warm up time.
- Then using the arrow key press it once, the back of the treadmill will lower.
- If you gently adjust the incline by one percent every other day, your dog should be very comfortable with this. If your dog shows any signs of stress, or fatigue bring the treadmill back up to the 0% gradient using the arrow key.
- Slowly re-introduce your dog by adjusting over a longer period of time.

DECLINE FUNCTION

- This function is available on all of our Fit Fur Life models
- This function should be used when the dog has become totally comfortable with the walking gait and striding out gait.
- The decline function is again very finely adjusted in minus single increments. It is motorized, quiet and smooth.
- Make sure your dog is in a walking gait for a few minutes to warm up.

- Using the arrow keys once the slope option is selected press it once and the back of the treadmill will come up.
- If you gently adjust the decline by minus one percent every other day, your dog should be comfortable with this. If your dog shows any signs of stress or unsteadiness bring the treadmill back down to the 0% gradient using the arrow keys once the slope option is selected
- Slowly re-introduce your dog by adjusting over a longer period of time.

Building muscle content in your dog

- Your dog may need more muscle content because it is an athlete and works and therefore needs to build up throughout its body or your dog may be overweight and by increasing the muscle mass it promotes more fat burning to occur.
- Your dog may need to increase muscle because it has had an injury and the muscle wastage that occurs when they don't use the joint is rapid or your dog may be a young puppy and is favouring one side whilst it is developing, and it has uneven muscle content.
Follow the guide lines below.
- Please ensure that your dog has become familiar with the treadmill, and that he/she is comfortable with the walking gait and the striding out gait.
- Always warm your dog up for 3-4 minutes and then you use the incline function for building up any muscle groups that are either side of the spine or over the rear quarters and down the hind legs.
- Or, if you need to build up muscle on the front end of the dog, shoulders or front limbs then use the decline function.
- Start with 3 to 5 minute sessions with the dog in a walking gait or striding out gait depending on the reason for use. Every time you use it adjust the arrow keys. Over a period of 2 weeks the dog should be using the full incline or decline option.
- For best results use the treadmill every other day, this allows the muscles to rebuild and repair in the day off.
- Slowly build the time of the sessions up to a maximum of 30 minutes. To get to this length of time it should have taken about 4 weeks.

- Once your dog has been using the incline or decline function for 6 weeks the muscle development in the wasted areas should really start to show an improvement.
- When you feel your dog has rebuilt the muscle, then maintain with three sessions a week. Make sure you alternate using the horizontal plain as well as the different gradients to allow for even muscle distribution.
- To produce good muscle tone in a dog requires the dog to be increasing its cardiovascular rate up high and maintaining that for a length of time.
- To do this your dog must be comfortable in the striding out gait and trotting gait.
- Please ensure your dog has had practice in these paces and has experienced different gradients.
- You need to build your dog up slowly, but the length of time that you can maintain a good pace, produces good tone on a dog.
- If your dog is familiar with the trotting pace, then by building the length of time that he/she does this will rapidly show results.



- Do not trot your dog for more than 20 minutes, and always be by its side.
- You must build up to this length of time over a period of 6 weeks, it is very intensive and you must watch for signs of fatigue.

Reducing fat content in overweight dogs

- Dogs that are overweight, due to being over fed, an injury or old age are sluggish and lacking in energy.
- By slowly getting them on the treadmill and increasing their cardiovascular rate they will change dramatically, both mentally and physically.
- Your dog must start of very slowly, with 2 – 4 minutes twice a day. It allows your dog to start to become more fluid in its movements and gently increases the cardiovascular rate.



- You are better using the treadmill in the first 2 to 3 weeks twice a day but for shorter periods.
- It is the same principle as for humans – little and often and then it is safe, allowing muscles to develop and the body to start moving again.
- When the dog starts to get to 10 minute sessions then drop down to using the treadmill once a day.
- After 6 weeks you should see dramatic results and changes in your dog.
- At this stage use the treadmill 3 times a week to maintain the dog in its new vibrant life style.

General guidelines

- Whenever the dog goes on the treadmill always allow he/she a 3 – 4 minute warm up and 3 - 4 minute cool down period. If this is not done your dog could injure itself.
- Increase protein levels in your dog's diet if you wish to increase muscle content.
- Reduce calorie intake and tit bits if reducing fat content.
- Remember to divide your dog's normal walk time by 2 and this should be the maximum amount of time on the treadmill per session. For example, if you walk for 30 minutes then the dog should be on the treadmill for a maximum of 15 minutes. The treadmill is there to use as an extra form of exercise, not to replace walks.
- Remember Slowly, Slowly, Slowly is the only way to go when your dog first starts on the Fit Fur Life treadmill.
- Signs to be aware of when your dog is tiring:
 - (1) The dog's head will start to drop continuously, (this is why the Fit Fur Life treadmill does not recommend fastening the dog's head to an overhead crossbar, instead use the harness provided).
 - (2) Dropping back on the treadmill means the dog cannot maintain its position and is tiring.
- Using the harness once your dog is used to the treadmill, will enable you to attach the yellow safety cut out mechanism to the harness. If pulled the magnet will come away from the console and the power will cut off stopping the treadmill.

- Allow your dog a 5 minute warm up and cool down.

Disclaimer

- Read the terms and conditions booklet

Technical specifications

Professional model :

Running area : 6' 7" x 1' 5"

Front and rear 2.36" steel tapered rollers

2HP motor

Incline +10 to -5 in 0.1 increments

4 window display

Wire mesh 5' 4" x 1' 10"

Speed 0.25~12.5 mph / 0.4~20 kmph

Max. dog's weight : 308 lbs or 139 kgs

Machine's net weight : 193.5 lbs or 88 kgs

Foldable

Large, Medium and Small harness included



Superior model :

Running area : 6' 7" x 1' 5"

Front and rear 2.36" steel tapered rollers

1.5HP motor

Incline +10 to -5 in 0.1 increments

4 window display

Wire mesh 5' 4" x 1' 10"

Speed 0.25~12.5 mph or 0.4~20 kmph

Max. dog's weight : 264 lbs or 119 kgs

Machine's net weight : 191.5 lbs or 87 kgs

Foldable

Large breed harness included

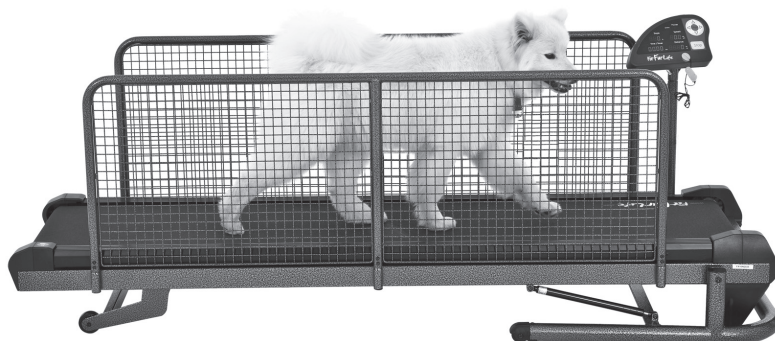

Medium model :

Running area : 5' 3" x 1' 5"

Front and rear 2.36" steel tapered rollers

1.25HP motor

Incline +10 to -5 in 0.1 increments

4 window display

Wire mesh 4' x 1' 10"

Speed 0.5~7.5 mph or 0.8~12 kmph

Max. dog's weight : 220 lbs or 98 kgs

Machine's net weight : 167.2 lbs or 75 kgs

Foldable

Medium breed harness included

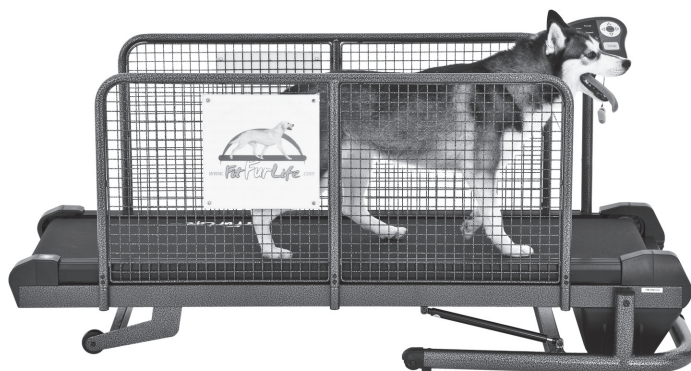

Small model :

Running area : 3' 11" x 1' 5"

Front and rear 2.36" steel tapered rollers

1HP motor

Incline +10 to -5 in 0.1 increments

4 window display

Wire mesh 2' 8" x 1' 10"

Speed 0.5~7.5 mph or 0.8~12 kmph

Max. dog's weight : 176 lbs or 79 kgs

Machine's net weight : 145.2 lbs or 65 kgs

Foldable

Small harness included



Warranty / guarantee policy

Read the Terms and Conditions booklet.

Warranty is automatically generated at the time of purchase. The date on your invoice is the start of your two year warranty.



Terms and Conditions

About us - Fit Fur Life Treadmills

We have been manufacturing treadmills for dogs since 2004. Designed in the UK and manufactured in Taiwan we ship all over the country and internationally too. Fit Fur Life treadmills can be supplied through various distributors and agents as well as direct from the manufacturer.

Fit Fur Life is continuously developing our range, we aim to meet everyone's requirements, and so if you have a good idea for any improvements we would be pleased to hear from you.

Our contact details:

Fit Fur Life Ltd
19 South Leys
Fernhurst
Surrey, GU27 3LD
United Kingdom

Phone: +44 (0)1428 652088

Email: sales@fitfurlife.com

VAT Registration Number: GB850 9884 83

Fit Fur Life Ltd is a company registered in England and Wales.
Company registration number 5619044.

Making a purchase

Making a purchase could not be easier. Just browse our website and then pick up the phone +44 (0)1428 652088 or email to sales@fitfurlife.com to receive advice from our top sales staff about which is the most suitable model for you and your animals requirements.

Once you have made your decision to purchase you can pay by the following methods:

Credit card; Bank transfer; PayPal;

You may phone, post or email your payment details to us at the above address.

We currently accept Visa, MasterCard, Delta, Switch, Maestro, Debit cards. All transactions are charged pounds sterling (£). We do not recommend sending payment details via regular email.

We have to have full payment from your credit card before any treadmill is dispatched for shipment.

By placing an order with us you will be deemed to have understood and agreed to these terms and conditions. If you do not agree or have any questions about any aspect of these contact us before placing an order.

These terms and conditions and your use of our website are governed by English law and you agree to submit to the non-exclusive jurisdiction of the English court. This does not affect your statutory rights.

Confirmation of your order

A contract in the form of an invoice will exist between us once we have emailed or posted to you the invoice to the address given to us. In the event that a deposit has been given, note that all deposits are non-refundable. You can place an order in one of two ways, either by email or over the telephone.

Non-acceptance of an order may be a result of one of the following:

The product you ordered being out of stock

Our inability to obtain authorisation for your payment

The identification of a pricing or product description error

Acceptance of an order placed by you will take place when your order is dispatched, unless you have cancelled the order in accordance with the Order Cancellation instructions set out below.

All goods remain the property of Fit Fur Life Ltd until paid for in full. Our invoice on order of acknowledgement do not signify acceptance of your order. We will check availability, pricing and your payment prior to acceptance and dispatch. Once we know we are ready to ship your order, your credit card (if used) will be charged and you will receive an order confirmation email telling you when to expect your goods.

Returns

You may normally return your order for any reason within 7 days of delivery of the treadmill. To do so you must give us written notice (including email) within that 7 day period. If you do cancel the contract within this time any payments made by you will be refunded in full within 30 days, excluding deposits and delivery charges. Cancelled items must be returned to us in the manner set out in our Returns Policy and must be received by us complete, in perfect condition, unused, and in their original packaging. Delivery charges will not be refunded.

Shipping and handling

Please phone the office for an estimated delivery time. We will ship your order right away if we have stock.

Purchases for delivery in the UK or mainland Europe will normally be delivered to you within 7 - 21 days of placing your order. For other destinations, times may vary. When your order is despatched we will advise by telephone or email. Delivery will usually be made by a courier service.

UK delivery

All goods are carefully packed and shipped as soon as they are available to fulfil your order. Delivery will usually be made within 7 - 14 days of despatch.

Overseas delivery

Overseas, BFPO and non-mainland UK (Channel Islands, Guernsey, Northern Ireland, Isle of Man, Northern areas of Scotland and Orkney Isles, Outer Hebrides and the Shetland Isles) shipping is charged at cost and may vary from the UK delivery charges. We will confirm the costs when we send you notification of acceptance of your order. Delivery times may vary please allow 7 - 21 days.

These items are heavy and we cannot guarantee that it will be a two man delivery service outside of UK. Please make sure you have sufficient help when unloading your treadmill.

For all our deliveries a signature will be required. Do not sign until you have inspected your goods. We will not be deemed responsible for any signatures given before inspection for damages has taken place.

Delivery schedule

Please note that all the products and services, including those “on offer”, are subject to availability and may be withdrawn at any time, including after you have placed your order.

If your item is not in stock, we will back order it for you. In case of long delays of unavailability, you will always be notified.

We always endeavour to ensure the accuracy of the information provided but, inevitably, there is the possibility of us being “Out of Stock”.

Disclaimer

To the fullest extent permitted by the law and except in respect of death or personal injury caused by negligence on the part of Fit Fur Life Ltd, its directors or employees, Fit Fur Life Ltd. Shall not be liable to you by reason of any representation (unless fraudulent), or any implied warranty, condition or other term, or any duty at common law, or under the express terms of the contract, for any indirect, special or consequential loss or damage (whether for loss of profit. or otherwise), costs, expenses or other claims for compensation whatsoever (whether caused by negligence on the part of Fit Fur Life Ltd, its directors, employees, or agents or otherwise) which arise out of or in connection with the use of our website.

We will not be liable to you or be deemed to be in breach of the contract by reason of any delay in performing, or any failure to perform, any of our obligations in relations to the products ordered by you, if the delay or failure was due to any cause beyond our reasonable control. This does not affect your statutory rights.

Tax charges

All prices quoted are in pounds sterling.

UK Tax (VAT) is not included in the item price. Where VAT applies it will be added to your order for orders delivered within UK. You are exempt from VAT charges if you live outside of the UK.

For all orders placed for delivery outside the United Kingdom and EU, any customs or import duties levied once the treadmill reaches your destination country are your responsibility to settle. We have no control over these charges and cannot predict what they will be.

Copyright

The contents of these pages (including pictures, designs, logos, photographs, text written and other materials) are the copyright trademark or registered trademark of Fit Fur Life Ltd or its suppliers. ALL RIGHTS RESERVED. The copying modification distribution reproduction or incorporation into any other work or part or all of the material available on our website, brochures and leaflets is not allowed. You may however:

1. Copy, print or download extracts of the material on our website for the purpose of placing an order with Fit Fur Life Ltd.
2. Copy, print or download the material on this site for the purpose of sending to individual third parties for their personal information.

Guarantee

If you are not totally satisfied with your purchase return it to the address below within 7 days of the date of dispatch, with your receipt, with its original packaging for a full refund of the purchase price of the product you paid. We recommend that you obtain proof of posting since we cannot be responsible for packages lost in transit. Please see our Returns Policy.

On receiving your goods, please check the packaging and machine for damages. If you suspect there are damages, please do not sign the delivery note. You are within your rights to refuse delivery of the goods. If however we receive the refused goods, and there are no damages apparent then you will be liable for delivery and return charges.

Coverage of warranty

3. This warranty (see Exclusions) confers upon your specific rights and remedies against Fit Fur Life Ltd. Please read this document carefully, by making a claim under this Limited Warranty, you will be deemed to have understood and accepted its terms. This Limited Warranty does not operate to limit such rights.
4. Fit Fur Life provides a 24 months warranty for parts only. Please note engineering costs are not covered.
5. Fit Fur Life Ltd warrants any Fit Fur Life product, including genuine parts and components (offered as accessories) which have been installed in your Fit Fur Life product at the time of purchase, first sold to an end-user to be free from defects in materials and/or workmanship under conditions of normal use for the duration of the warranty period specified.

6. Any software supplied with your product, including the operating system, is provided "As is". Fit Fur Life does not warrant that the operation of any software supplied with your product will be uninterrupted or error-free, or that such software will meet your requirements.
7. If you make a claim under this Warranty, Fit Fur Life will, at its option, repair or replace any defective product or any parts thereof covered by this Warranty by using new or factory-refurbished parts of products. In the event that Fit Fur Life opts to use factory-refurbished parts or products, they will have performance characteristics equal to those of new products. All exchanged parts and products replaced under this Warranty will become the property of Fit Fur Life. All exchanged parts and products must be returned to Fit Fur Life Ltd in the UK. Fit Fur Life reserves the right to charge for the parts and products if they are not returned.
8. The Warranty period commences on the date of purchase. Your original purchase invoice, showing the date of purchase of your product, is your proof of the date of purchase.

Exclusions and limitations

1. If no receipt is provided then no warranty will be honoured. Any product that has been damaged or rendered defective as a result of misuse by keeping the treadmill in damp and dirty or humid conditions.
2. Any product that is kept outside in conditions below minus 10 degrees or above 40 degrees.
3. Any product that is not lubricated and kept free of hair or faeces.
4. Use of the product other than for its normal intended use for animals.
5. Failure to use the product in accordance with the Owners Manual maintenance instructions section.
6. Modification of the product including use of parts not manufactured and or sold by Fit Fur Life Ltd.
7. Service or repair by anyone other than Fit Fur Life or a Fit Fur Life Authorized Service Provider.
8. Improper transportation or packing when returning the product to Fit Fur Life or a Fit Fur Life Authorized Service Provider.

9. Loss of any or damage to, programmes, data, or removable storage media. You are responsible for saving (backing up) any programs or data.

10. Minor defects of LCD screens;

Please note that Fit Fur Life Ltd may opt to replace the product for warranty services with a remanufactured product of equal quality, and, thus, any data stored by you on your original product may become permanently inaccessible to you.

Fit Fur Life recommends that treadmills are serviced by a recognised engineer every 6 months under high usage and yearly for regular usage. Research human fitness equipment engineers in your area.

Registered Office: 19 South Leys, Fernhurst, Surrey, GU27 3LD
Registered in England No. 5619044
VAT No. 850 9884 83



In loving memory of Daffy, who became Fit Fur Life's logo
and his mum Beebee



Fit Fur Life Ltd

19 South Leys, Fernhurst, Haslemere, Surrey GU27 3LD, United Kingdom.

Phone: +44 (0)1428 652088 Email: sales@fitfurlife.com

www.fitfurlife.com